

HISTORIC CERTIFICATE OF APPROPRIATENESS

Application for Permit to:

Adjust, replace and repair sunken, defective and eroded foundation piers and floor joists and level existing structure.

Brick to be salvaged & reused where possible. Matching brick to be added if not enough is salvageable.

APPLICANT NAME: Richard Bell and Jayme Naquin

Email: ric@zizax.com jaymenaquin@gmail.com Phone: 504 214-1220 504 202-8658

Address: 22213 Level Street, Abita Springs, LA 70420

OWNER (IF DIFFERENT FROM APPLICANT):

Email: Phone:

Address:

SUBJECT PROPERTY

Street Address or Legal Description: 22213 Level Street, Abita Springs, LA 70420

CONTRACTOR INFORMATION

Contractor's Name and Company: Davie Shoring, Inc (Kevin Harless)

Email: kevinh@davieshoring.com Phone: 504 464-4712

Address: PO BOX 489, Natalbany, LA 70451

Work Begins: ASAP Estimated Completion Date:

Signature of Owner

Signature of Applicant

Do Not Write Below this Line

Review Date:
Approved:
Rejected:
Tabled for Review:
Public Hearing:
Signature:

List of Attachments:
Follow-up Done On:
Worked Completed as Presented:
Further Action Needed:

Historic Commission Chairman

HISTORIC CERTIFICATE OF APPROPRIATENESS

Historic Check List

Name: Richard Bell and Jayme Naquin

Date: Feb 28, 2024

Address: 22213 Level Street Abita Springs, LA 70420

FOUNDATION Concrete Block Brick Continuous Chain Wall Raised Slab (36" above ground)

CRAWLSPACE 24" Clear

SIDING Vinyl Wood Hardie Plank

ROOF Metal Fiberglass Shingles Slope: 8/12 Minimum

FRONT PORCH Wood 7' Deep 2/3 Minimum Front Width of House: Yes No

CHIMNEY Stovepipe Brick None

STEPS Wood Bricks Railing: Wood Spacing 4"

HEIGHT Height of Building: 35' Maximum

WINDOW TRIM Vinyl Wood Hardie Plank Other

TRIM Vinyl Wood Hardie Plank Other

COLUMNS Vinyl Wood Hardie Plank Other

DOORS Vinyl Wood Hardie Plank Other

SHUTTERS Vinyl Wood Hardie Plank Must be 1/2 Width of Windows Yes No

ACCESSORY BUILDINGS Garage Shed Other

FENCES Wood Type: 4' Picket 6' Privacy 6' Privacy with 2' Lattice

LIGHTING No Exposed Fluorescents

SIGNS Permanent Temporary

Jayme Naquin
Homeowner

2/28/24

Date

Commissioner

Date

Google Maps 22213 Level St

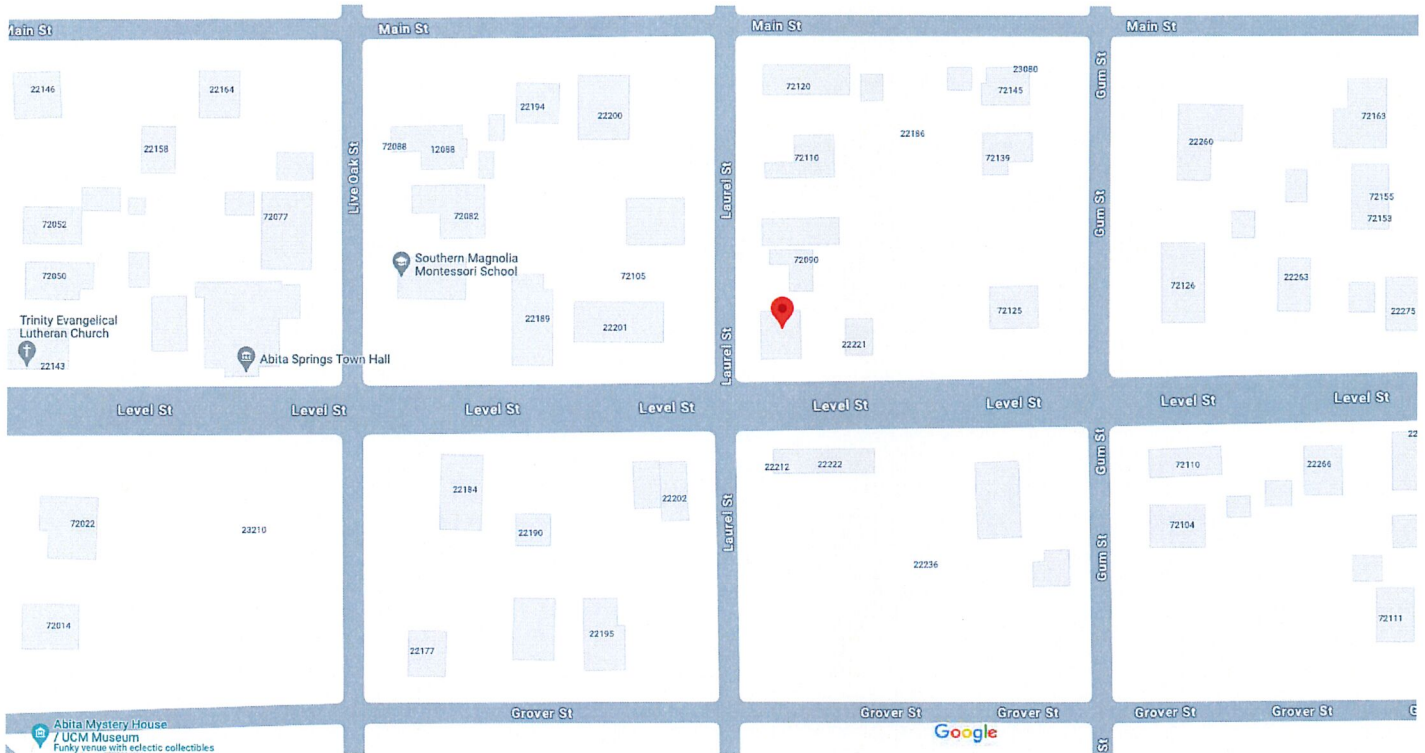







Map data ©2024 Google 50 ft



22213 Level St

Building

-  Directions
-  Save
-  Nearby
-  Send to phone
-  Share

 22213 Level St, Abita Springs, LA 70420

Photos

A SURVEY OF THE PROPERTY
OF
MARY ANN PATTESON

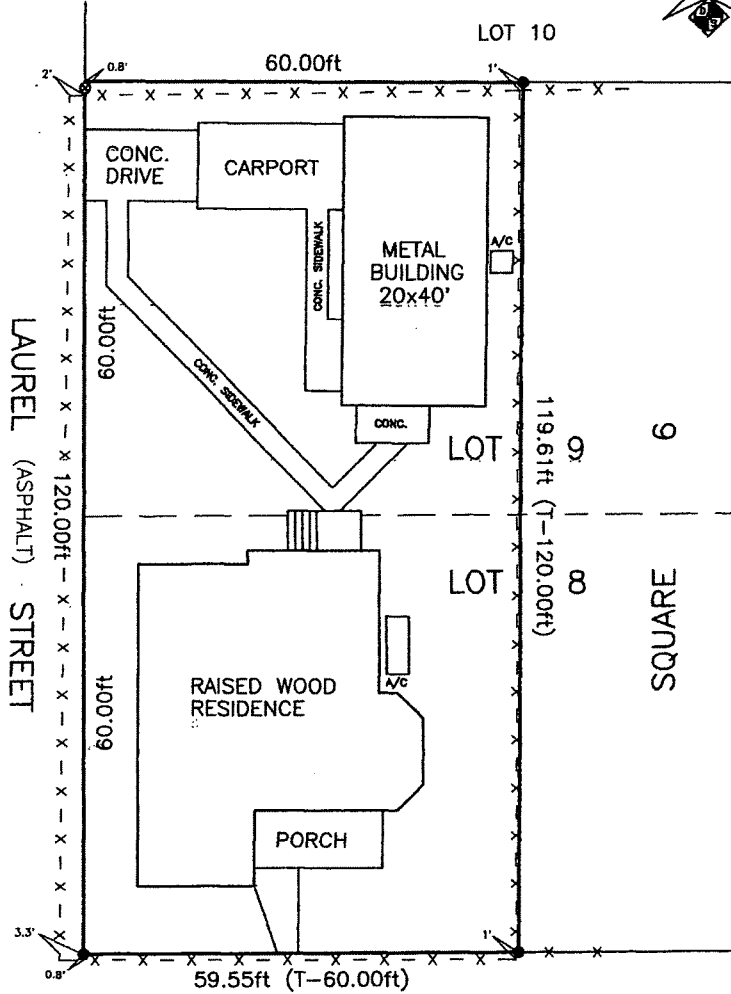

LEGEND

- 1/2" IRON ROD FOUND
- MAG SPIKE SET IN 18" OAK STUMP

#22213 LEVEL STREET (ASPHALT)

Reference 1) PLAT OF THE TOWN OF ABITA SPRINGS.
Reference 2) LEGAL DESCRIPTION RECORDED IN INSTRUMENT NUMBER 357626.
SAID TOWN OF ABITA SPRINGS PLAT AND DESCRIPTION FILED IN THE ST. TAMMANY PARISH CLERK OF COURT USED AS THE BASIS OF DIRECTION AND TITLE(T) CALLS.

NOTE 1) Said property is located in Flood Zone X per the Insurance Rate Map for Town of Abita Springs, Community Panel # 220199 0001C Map Effective, 05/17/1988 Base Flood Elevation N/A

NOTE 2) The undersigned surveyor has not performed a title search or abstract. This survey was conducted using documents provided by the client or their agents. Servitudes shown are not necessarily exclusive. Servitudes of record will be added hereto upon request after a title opinion. Plat Revised

I certify this plat represents an actual ground survey in accordance with the applicable standards of practice as stipulated by the Louisiana State Board of Registration for Professional Engineers and Land Surveyors and bears a C survey classification.

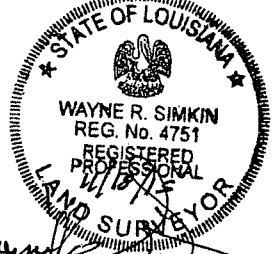

WAYNE R. SIMKIN P.L.S. REG. # 4751

SURVEY OF THE WEST HALF OF LOTS 8 AND 9,
SQUARE 6, TOWN OF ABITA SPRINGS,
ST. TAMMANY PARISH, LOUISIANA.

D & S SURVEYORS, INC.
PROFESSIONAL LAND SURVEYORS
228 WEST 21st AVENUE, COVINGTON, LOUISIANA 70433
OFFICE(985)892-2847~FAX(985)892-2806

JOB NO.	DRAWN WRS	DATE	SHEET NO.
15-100	CHECKED WRS	11/17/2015	1 OF 2
		SCALE 1"=20'	







Level Street (Front) View



Eroded Pier - SE



Eroded Pier - East



Existing Piers - East



Sinking Pier - East

Legend

- Pier x
- Adjust Pier: A
- Replace Pier: R
- Install Pier: I
- Install Bounce Beam:
- Replace Sill:
- Elevation (in): -0.4

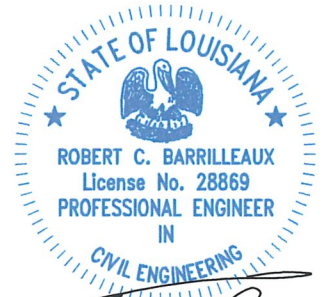
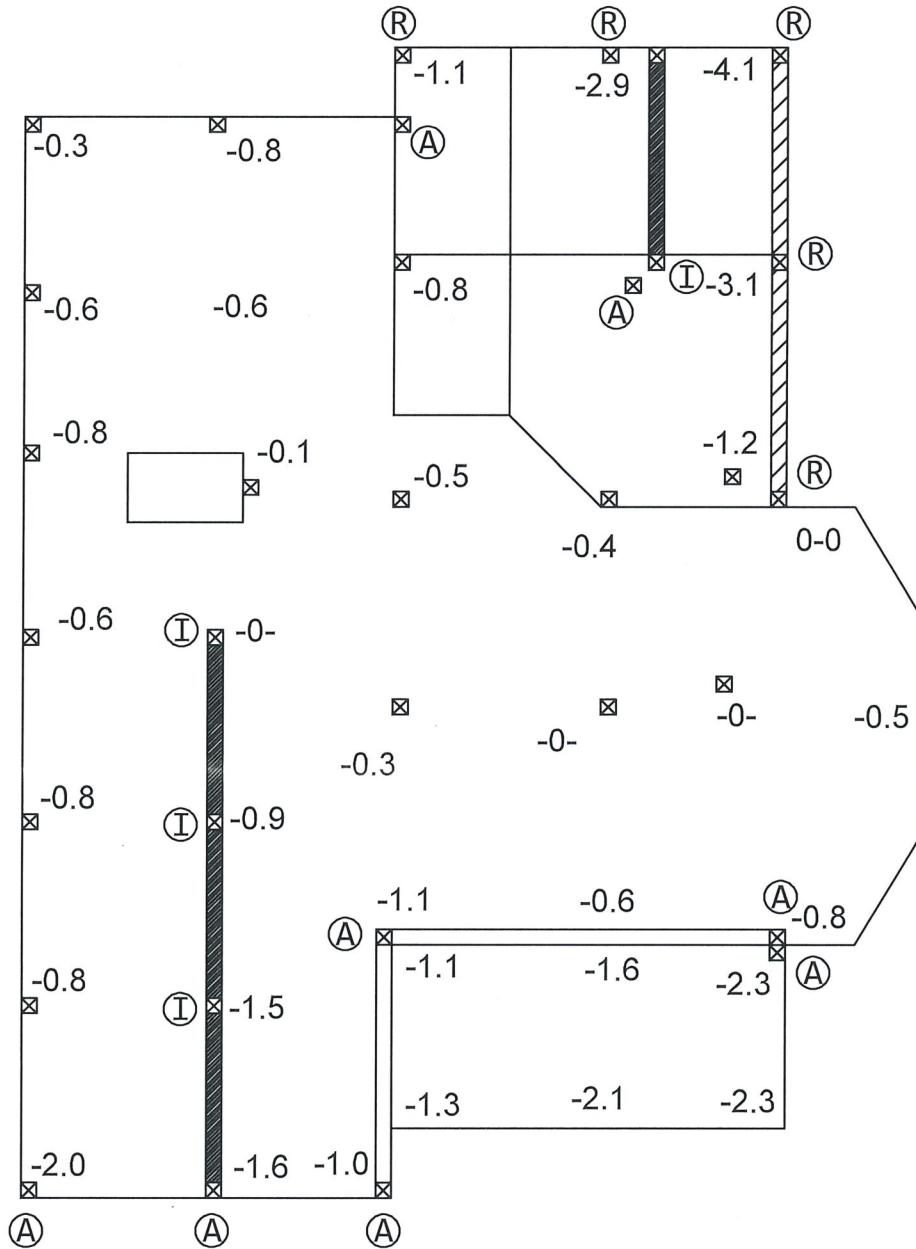

[Signature]
2/8/24

Notes:

- 1) Home has a wood framed foundation and has experienced settlement. Home is to be leveled by adjusting piers as shown and will undergo an approximately 4.1" lift to bring home back to level as close as possible.
- 2) Piers shall be adjusted by addition of 3000 psi precast concrete or steel shims with non-shrink grout around them.
- 3) All measurements and elevations provided by Davie Shoring, Inc.
- 4) Shoring is planned to be completed with:

Adjust Piers: 8
 Replace Piers: 5
 Install Piers: 4
 Install Bounce Beam: 37 LF
 Replace Sill: 20 LF

Pier Placement Shoring Plan
 Lift Company: Davie Shoring, Inc.

22213 Level Street
 Abita Springs, LA



Robert Barrilleaux & Associates, Inc.
 ph: (985)-542-0391 fax: (985)-542-6515
 42333 Deluxe Plaza Suite 8 Hammond, LA
 Engineer - Robert C. Barrilleaux, PE #28869

Date: Feb 8, 2024 Scale: 1" = 8'
 Drawn by: JQ Revised: