

8/10/2021

Town of Abita Springs

Date: 8/02/2021

☒ Owner
☐ Applicant

Type of Approval

☐ Sign ☒ Fence

☐ Other: _____

APPLICATION FOR PERMIT TO: (Briefly describe project- Use separate paper if necessary)

Erect a privacy wooden fence along the back of home and side on level street.

APPLICANT NAME: Melissa Kyle

Email: 0520melissa@charter.net Phone: 985-264-3117

Address: 22180 Grover St, Abita Springs, LA 70420

OWNER (IF DIFFERENT FROM APPLICANT):

Email: Phone:

Address:

CONTRACTOR NAME & COMPANY: Repair-It-Rite / James Simmons

Email: kool-it-rite@yahoo.com Phone: 985-966-1342

Address: 307 Chestnut St, Mandeville, LA 70471

Melissa N. Kyle 8/02/2021

Signature of Owner

Date

Signature of Applicant

Date

----- Do Not Write Below this Line -----

7 DAYS NOTICE REQUIRED BEFORE FINAL APPROVAL OF CONSTRUCTION. IF YOU BUILD IN THE HISTORIC DISTRICT APPROVAL MUST BE GIVEN BEFORE YOUR CERTIFICATE OF OCCUPANCY WILL BE ISSUED.

Commissioners Initial

Ron Blitch _____

Otto Dinkelacker _____

Thad Mancil _____

Andre Monnot _____

Paul Vogt _____

Review Date: _____

Approved: _____

Commissioner Assigned: _____

Work Completed as Presented: _____

Inspected on Date: _____

Town of Abita Springs

SUBJECT PROPERTY

Street Address or Legal Description: 22180 Grover St., Abita Springs
Nearest Cross Streets: Corner Grover & Live Oak Lot Dimensions: 60' X 110' (see attached)
Work Begins: Upon approval of application Estimated Completion Date: A week from approval

DETAILS ABOUT YOUR SIGN OR FENCE

SIGNS

Location: ☒ Permanent ☐ Temporary Location: ☐ On Building ☐ Hanging
Size of Sign: Two-Sided Sign? ☐ Yes ☐ No
Sign Material: Post Material:
Height of Sign:
Describe Sign Lighting:
Notes:

FENCE

Location: Along back of house and side on Live Oak.
Style: Height: 7-8 ft.
Material: Cedar
Type: ☒ 4' Picket ☒ 7' Privacy ☒ 6' Privacy with 2' Lattice (Tallest allowed)
Set Back Requirements:

Notes: approx. 12' which is first 1/3 of house depth, height will be 4'. Will move white picket to house corner

PAINT DETAILS

Details: Rest of fence will be 7' privacy fence

OTHER

Give Details:

8/2/2021

22180 Grover St - Google Maps

Google Maps 22180 Grover St

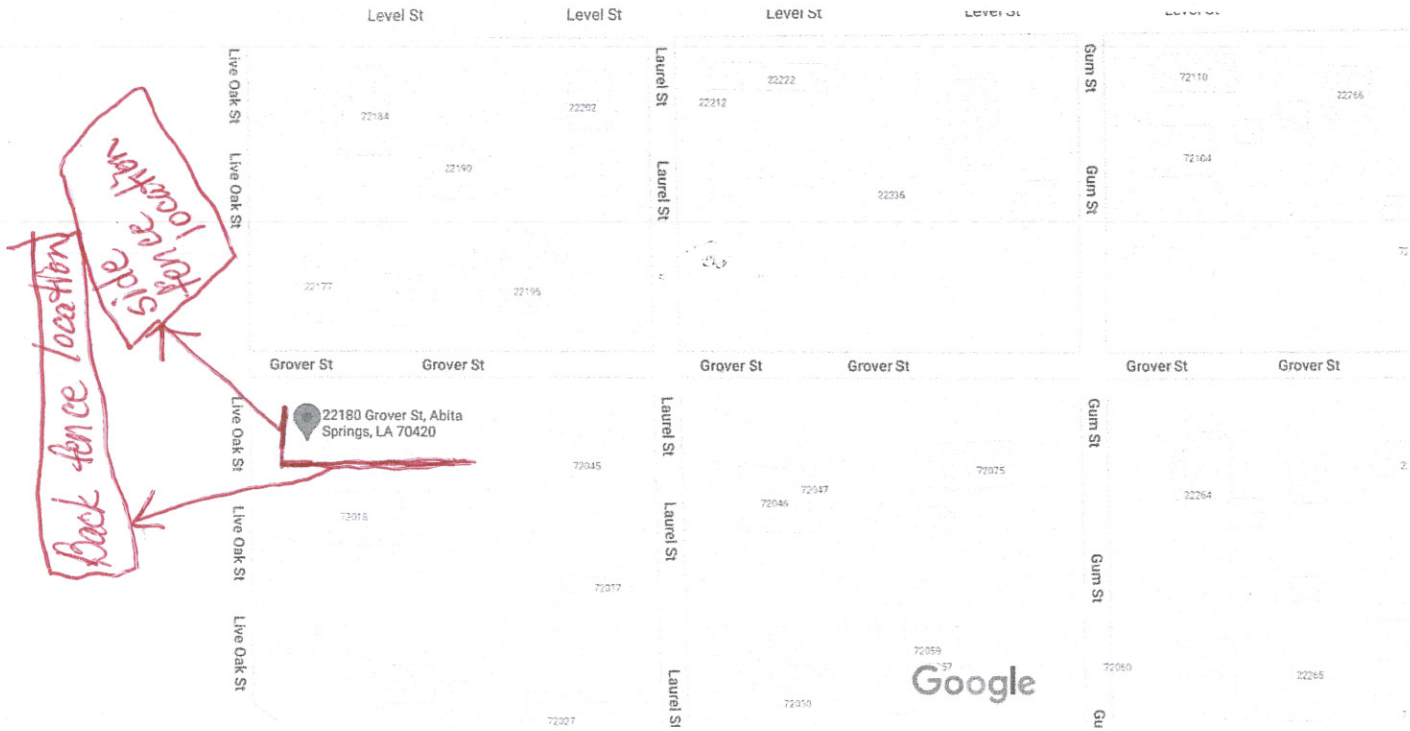



- 4' PICKET FENCE
- 7' PRIVACY FENCE



Image capture: Jan 2019 © 2021 Google

Abita Springs, Louisiana



Street View



Currently shown: Jan 2019

